

# Multicat Costal Discovery

## Dp Shallow Draft Multi Cat 3512



### CLASSIFICATION / FLAG

Flag	Kazakh
Trading area	Unrestricted
Call sign	PBUZ
IMO	9563861
Classification society	Bureau Veritas
Class ship type	Special Service - Multipurpose ship
Class notation	1✠ Hull ● Mach ✠ AUT-UMS Unrestricted navigation
Safety equipment	Max. 17 persons
Dynamic Position Installation	DP-0 (Not Class certified - 4 Thrusters)

### PRINCIPAL DIMENSIONS

Length o.a.	35,85 m
Breadth o.a.	11,84 m
Draft	1,48 (shallow) - 2,00 (max) m Min. 1,48 mtr Max. 2,00 mtr. Nozzle/rudder ext. below keel + 0,00 mtr.
Max. Deadweight	301 ton
GRT	396
NRT	118
Max. deck load	5 ton/m <sup>2</sup>
Free deck space	200

### ACCOMMODATION

Accommodation	Fully airconditioned, complement 12 persons 2x single berth cabins 5x double berth cabins
---------------	--

### NAVIGATION AND COMMUNICATION SYSTEMS

GMDSS	A1, A2, A3
V-SAT	Available

### MACHINERY / PROPULSION

Maximum speed	10 knots
Bollard pull	24 ton
Power output	1757 kW
Propulsion	Twin fixed pitch propellers in nozzles
Main engines	4x Caterpillar C-18 ACERT 447 kW
Auxiliary engines	2x Caterpillar C-9 187 kVA - 400V/50Hz 1x Caterpillar C 4.4 45 kVA 400V/50HZ
Bow thruster	360° azimuth thruster 447 kW
Stern thruster	360° azimuth thruster 416 kW

### DECK EQUIPMENT

Winch AHT	50 ton - 7 m/min. 25 ton - 21 m/min. Holding moment 120.000 Nm
Tugger winch	10 ton - 12 m/min.
Towing hook	25 ton
Hydraulic deck crane	Heila HLRM-4S 200 tm Fixed hook SWL 9 ton - 16,31 mtr. Wire winch SWL 10 ton
Moonpool	Situated on SB-side fore ship with 620 mm diam.

### TANK CAPACITIES

Fresh water	70 m <sup>3</sup>
Fuel	208 m <sup>3</sup>
Sewage	35 m <sup>3</sup>
Ballast water	37 m <sup>3</sup>
Black/grey water	3,6 m <sup>3</sup>
Dirty oil	3,6 m <sup>3</sup>

# Multicat Coastal Discovery

Dp Shallow Draft Multi Cat 3512

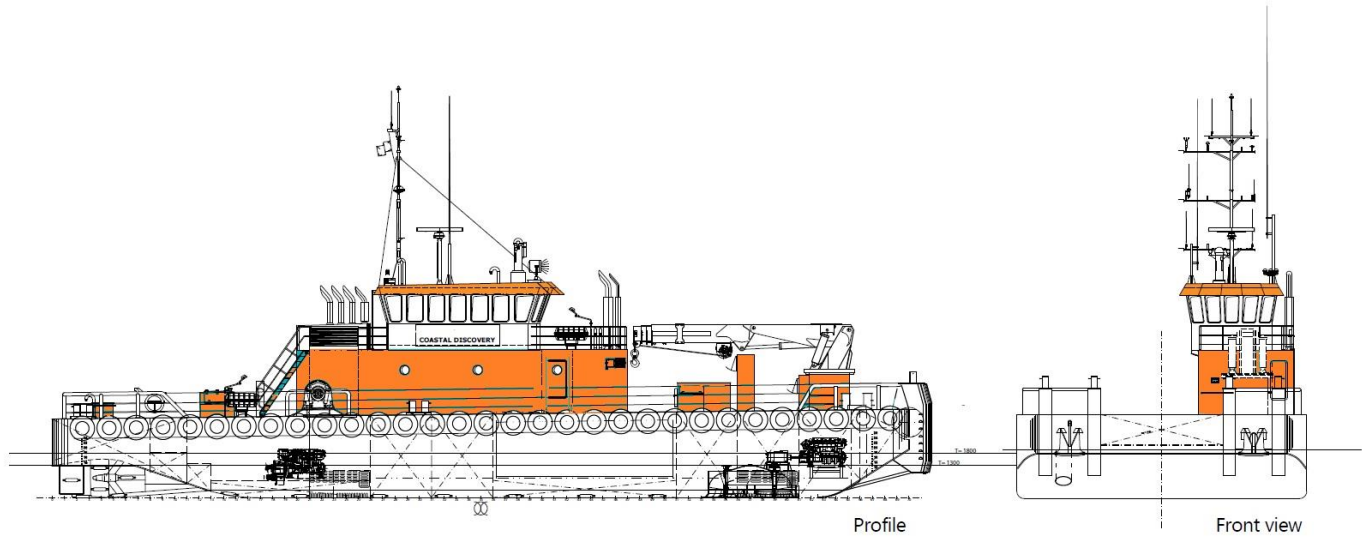

Profile

Front view

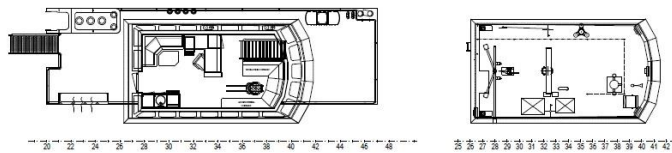

Bridge deck

Top deck

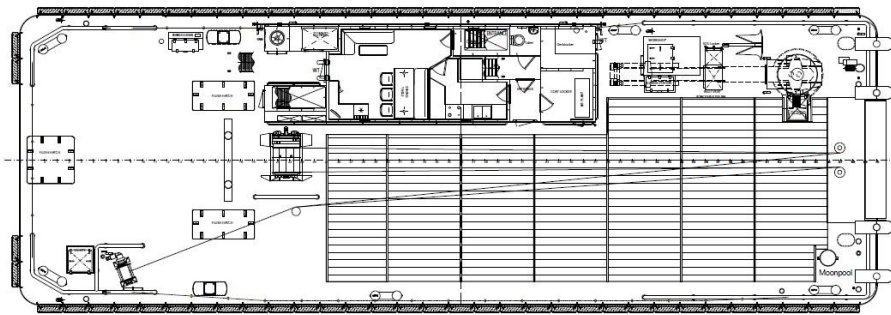

Main deck

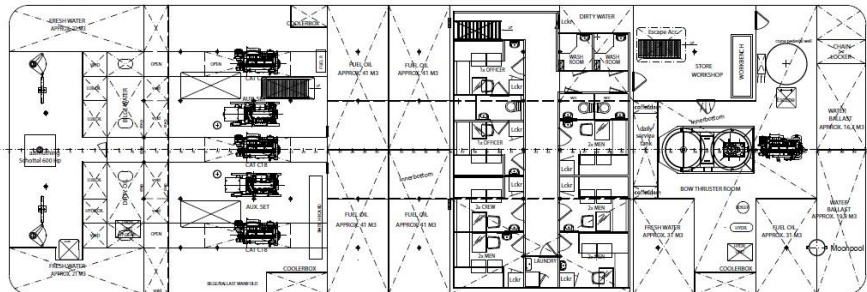

Below main deck